

# MANUAL



# MASK2

## **Features**

*Smaller, cuter, easier... don't be fooled by the tiny appearance...*

The APart MASK2 speakers are simply amazing. No need to say more; you will hear what we mean. Designed to fit in any interior, and applicable in many situations, they will not disappoint you. These speakers have been designed for the true music lover, with the installer in mind. Popular applications are home hifi systems, home cinema surround systems, multiroom audio systems, convention rooms, shops, you name it...These speakers are a perfect match for any application requiring great hifi sound in small to medium sized rooms.

Special brackets are supplied with the speakers, allowing them to be mounted under various angles to solid surfaces such as walls or ceilings.

**IMPORTANT NOTES: these speakers will perform flawlessly only when you follow our amplifier and system recommendations. Do not attempt to use these small speakers as full range speakers, they are not designed to reproduce bass frequencies. We strongly recommend the use of our matching subwoofers or matching highpass filter systems. Our recommended subwoofers and amplifier systems have special tailor made protection and filter circuits, avoiding damage due to overloads and guaranteeing true hifi experience. These overload protection systems are incorporated in the subwoofers and amplifiers, NOT in the MASK2 speaker itself.**

These speakers are NOT magnetically shielded, so if you have a CRT screen, place the speakers at sufficient distance from the screen. Modern plasma, LCD, TFT or LED screens are insensitive to magnetic interference, so you can install these speakers close to such devices without limitations.

For possible and supported speaker/amp combinations, ask your dealer or take a look at our speaker sets on our website :

[www.apart-audio.com](http://www.apart-audio.com)



## **Unpacking**

These speakers have been carefully packed at the factory. Open the carton box and remove the speakers from the packing. Do not use sharp objects to remove the protective bag from the speaker. The removable grille is already in place and should not be taken off. Place the speakers on a flat surface. The mounting brackets are included in the packing, and the mounting accessories (screws, plugs and screw caps) are located in a plastic bag underneath the protective carton. When the product shows signs of damage caused by transportation, contact your dealer immediately. Damage due to transport and rough handling is not covered by the manufacturers warranty.

## **Wall mounting the speaker**



It is recommended to point the center of the speaker to the center of the dedicated listening area, but this is not so critical because Mask 2 has a wide dispersion range. Before mounting the bracket on the wall or ceiling, test-fit the speaker-bracket combination to see if you reach the desired mounting angle. Determine the position of the mounting holes using the bracket as a template and drill the holes.



Using the appropriate mounting hardware, mount the bracket to the surface. Mounting materials for solid brick walls are included. For other materials you may need other hardware, available from your local hardware store.



Once all screws have been securely tightened, place the included screw covers in place.

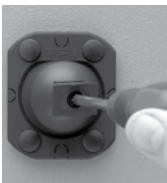

The angle can be determined by the position of the bracket base and the position of the H-hook on the half-sphere ball. The factory default force-setting of this central screw is adjusted for moving the H-hook over the semi-sphere with or without the cabinet being over the hook. It is allowed to adjust the angle by moving the cabinet and the H-hook together after the mounting has been realized. You can fasten or loosen the central screw to influence the turning force of the H-hook.



Now slide out the rubber security piece from the back of the speaker, slide the speaker on the H-hook of the mounting bracket. Slide the rubber part back in place to lock and secure the cabinet. Plug the euroblock connector into the speaker.



Consider to hide the speaker cable by guiding it through one of the 4 pre-cut cable-entries on the sides of the bracket base. Such a pre-cut cable entry can be easily cut away. From here you can lead the speaker wire to the connector.

## **Corner mounting the speaker**



When you need to mount the speakers under a very wide or difficult angle, first rotate the base plate by 45 or 90 degrees in order to get the maximum tilt angle into the right direction. Another method of getting a special angle, especially for ceiling mouting, is to turn the H-hook by 180°.



Now slide out the rubber security piece from the back of the speaker, slide the speaker on the H-hook of the mounting bracket. Slide the rubber part back in place to lock and secure the cabinet. Plug the euroblock connector into the speaker.

## **Ceiling mounting the speaker**



Using the appropriate mounting hardware, mount the bracket to the ceiling. Mounting materials for solid brick walls are included. For other materials you may need other hardware, available from your local hardware store. Slide the speaker onto the mounting bracket in such a way that it won't slide off even without the rubber locking piece in place. After you slide on the speaker, slide the rubber part back in place to lock and secure the cabinet. Plug the euroblock connector into the speaker.

## Connecting the speaker

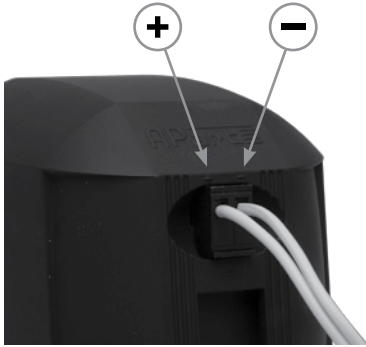
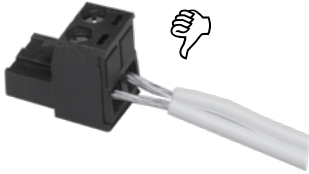

Remove the euroblock connector from the speaker and connect the speaker wire to the euroblock connector. Mind the polarity marked on the back of the speaker: + is positive, - is negative. Most speaker wires have a colour code. Respect the colour code starting at your amplifier up to your speakers. For distances up to 20 meters, you can use 0.75 mm<sup>2</sup> speaker wire without any loss of performance. For longer distances, use thicker wire. The euroblocks accept wires up to 1.5 mm<sup>2</sup> and up to 2.5 mm<sup>2</sup> when using special so called 'cable shoes'.

## Testing the installation

Before you can enjoy your new speakers, recheck all connections. Correct any loose connections and avoid 'naked' wires causing short circuits, before using the system. Short circuits may cause damage to other system components.

Enjoy your new MASK2 speakers !

## **Technical specifications**

Speaker type	Full range 2.5" speaker
Nominal impedance	8Ω
Frequency range	120 - 20000Hz (without subwoofer)
Program power	50 Watts RMS (using a 150 Hz/12 dB/octave highpass filter.)
Recommended amplifier power / channel	10 - 110 Watts (with matching subwoofer)
Dimensions H x W x D mm	94 x 82 x 108 (without mounting bracket)
Distance from wall	approx 30mm using included brackets
Shipping weight	1300g (1 speaker pair with accessories)
Net weight	440g
Shipping dimensions mm	130 x 146 x 310
Accessories (supplied)	Mounting bracket, mounting hardware, screws and screw covers.

***Company names, product names, and names of formats etc. are the trademarks or registered trademarks of their respective owners.***

**© 2009 APart-Audio specifications subject to change without notice.**

