



Earphone Resource Center

Sound Isolating™ Earphones

Shure web site for all earphone related information.
Version: 6.2 (2022-K)

Table of Contents

Earphone Resource Center	3	Sound Isolating™ Earphones	3	Use with SE Earphones	10
Sound Isolating™ Earphones	3			BT2 FAQ	11
Detachable Cable	3			Remote + Mic, Telephony, Voice Command and In-App use	11
Using Earphones	3			Battery, Durability, Range and Charging	12
Choosing a Sleeve	4			Use with SE Earphones	12
Inserting the Earphones	4			Accessories	13
Changing Sleeves	5			Accessory Cables for Mobile Devices Quick Start Guides 1-3	
	5			In North America:	13
Removing the Earphones	5			Specifications	14
	5			Bluetooth Specifications	15
Maintenance and Cleaning	5			Battery Specifications	17
Cleaning the Earphone Nozzle	6			Headphone Amplifier Specifications	18
	6			SAFETY PRECAUTIONS	18
Shure Bluetooth® Earphones	6			WARNING FOR ALL EARPHONES!	19
	6			SAFETY PRECAUTIONS	19
Bluetooth Pairing	6			WARNING	19
Pairing Multiple Bluetooth Devices	7			CAUTION	19
Pairing Bluetooth Device to a PC	7			IMPORTANT SAFETY INSTRUCTIONS	19
Bluetooth Accessory Quick Start Guides	7			For Products That Use Bluetooth	20
Charging the Earphones	7			Information to the user	20
BT1 FAQ	8			Certifications	21
Remote + Mic, Telephony, Voice Command and In-App use	8			LIMITED WARRANTY	22
Battery, Durability, Range and Charging	9			FOR ORIGINAL PURCHASES IN AUSTRALIA ONLY	23
				Service and Repair Information	24
				Service Centers	24

Earphone Resource Center

Sound Isolating™ Earphones

Sound Isolating™ Earphones

Shure Sound Isolating™ Earphones, built with balanced armature speakers, deliver a detailed soundstage free from outside noise. The powerful and stylish Shure SE earphones come with a detachable cable, adapters, a durable carrying case, and interchangeable Sound Isolating sleeves for a comfortable and personalized fit.

For more information on how to wear Shure Earphones, view the [How to Properly Fit and Wear Shure Earphones](#) video tutorial.

For more information on how to wear Shure Earphones, view the [How to Change Shure Earphone Sleeves](#) video tutorial.

For more information on how to wear Shure Earphones, view the [How to Clean Shure Earphones](#) video tutorial.

Detachable Cable

You may need to detach the cable from the earphones to attach optional components or to replace the cable if it becomes damaged. To prevent accidental separation, the connector has a snug fit. Take special care to prevent damage to the earphone and connector.

- Do not use pliers or other tools.
- Grasp the connector and the earphone as close as possible to where they join.
- Pull straight apart—do not twist. Cable is a snap fit, not threaded.

Note: If you pull at an angle, the connector will not detach.

- Do not pull on the cable or put any pressure on the earphone nozzle.
- Listen for a click when connecting.
- When reattaching the cable, match the "L" and "R" markings. For clear cables and earphones, match the color dots (Red=Right, Blue=Left).

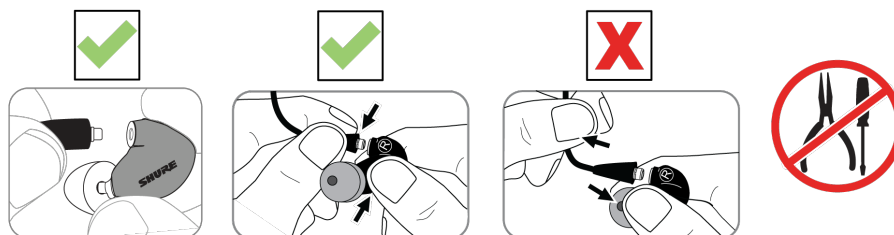



Audible click when properly connected

Using Earphones

Choosing a Sleeve

Select an earphone sleeve that provides the best fit and sound isolation. It should be easy to insert, fit comfortably, and easy to remove.

	<p>Soft Flex Sleeves: In small, medium, and large sizes. Made from pliable rubber.</p>
	<p>Soft Foam Sleeves: Compress the foam sleeve between your fingers and insert into the ear canal. Hold in place for about ten seconds while the foam expands.</p>
	<p>Triple-Flange Sleeves: If desired, use scissors to trim the stem on the sleeve.</p>

Inserting the Earphones

Carefully insert the earphone into the ear like an earplug, so that a tight seal is formed.

Important: If there is a lack of low frequency response (bass), the earphone sleeve may not be forming a proper seal. Gently push the earphone deeper into the ear canal or try using a different sleeve.

Warning: Do not push the earphone sleeve beyond the ear canal opening.

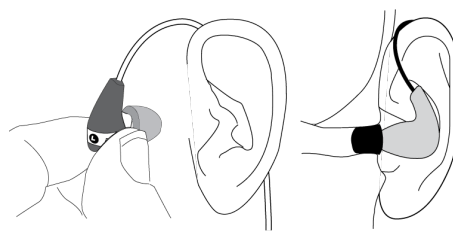

The fit of the earphone can greatly affect sound quality.

Wearing the Earphones

The following are some suggested ways of wearing the earphones.

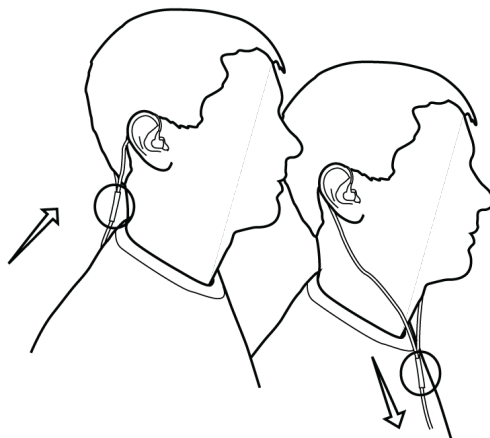

Wear the cable over the ear and secure it behind the head to help keep the earphones in place during physical activity.

Tighten the cable and take up slack by raising the cable cinch.

Changing Sleeves

- Twist and pull to remove the sleeve from the nozzle.
- Slide on a new sleeve so that it completely covers the barb and the nozzle.

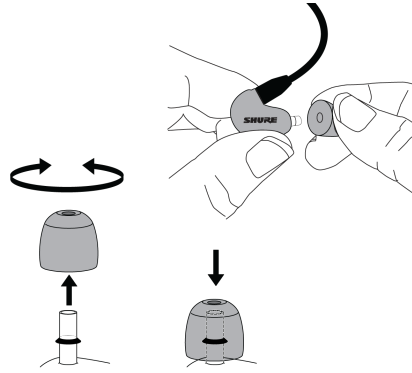

Caution: If the barb or any of the nozzle is exposed, the sleeve is not properly installed. Replace sleeves if they do not tightly grip the nozzle. To ensure proper fit and performance, use only sleeves supplied by Shure (unless using custom molded sleeves).

For more information on how to wear Shure Earphones, view the [How to Change Shure Earphone Sleeves](#) video tutorial.

Removing the Earphones

Grasp the body of earphone and gently twist to remove.

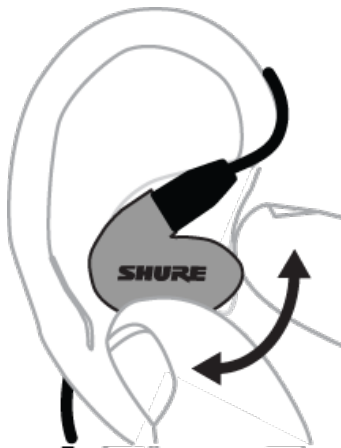

Note: Do not pull on cable to remove earphone.

For more information on how to wear Shure Earphones, view the [How to Properly Fit and Wear Shure Earphones](#) video tutorial.

Maintenance and Cleaning

Careful maintenance ensures a tight seal between the sleeve and nozzle, improving sound quality and product safety.

- Keep the earphones and sleeves as clean and dry as possible.
- To clean sleeves, remove them from earphones, gently rinse in warm water and air dry. Foam sleeves require a longer drying time. Inspect for damage and replace if necessary. Ear sleeves must be completely dry before reusing.
- Wipe the earphones and sleeves with mild antiseptic to avoid infections. Do not use alcohol-based disinfectants.
- Do not expose earphones to extreme temperatures.
- Replace sleeves if they do not fit properly.
- Do not attempt to modify this product. Doing so will void the warranty and could result in personal injury and/or product failure.

Cleaning the Earphone Nozzle

If you notice a change in sound quality, remove the sleeve and check the nozzle of your earphone. If nozzle is blocked, clear obstruction by using wire loop end of cleaning tool.

If no obstruction is found or if sound quality does not improve, replace the sleeve with a new sleeve.

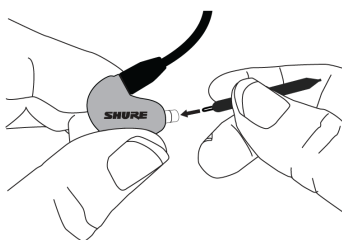

Cleaning Tool

Caution: When cleaning, do not force any object through the earphone nozzle! This will damage the earphone sound filter.

Warning: The cleaning tool is only to be used to clean the earphones. Any other use, such as using the tool to clean ears or foam sleeve, could result in injury.

The cable connectors to the earphones may collect debris or other deposits that can affect audio quality. If this happens, disconnect the cables and clean them using a dry cotton swab.

For more information on how to wear Shure Earphones, view the [How to Clean Shure Earphones](#) video tutorial.

Shure Bluetooth[®] Earphones

Shure Bluetooth earphones are designed for continued functionality with Bluetooth capable devices. They feature a three button controls with in-line microphone for phone calls and voice applications.

Bluetooth Pairing

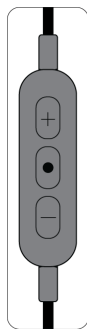

1. Turn off the earphones. Press and hold center button on earphone remote until the LED flashes blue and red.
2. From the bluetooth settings of your audio source, select your Shure bluetooth device.
3. LED turns blue when successfully paired.

Pairing Multiple Bluetooth Devices

1. Turn off the earphones. Press and hold center button on earphone remote until the LED flashes blue and red.
2. From your audio source, select "Shure BT1."
3. LED turns blue when successfully paired.

To pair second device:

1. Press and hold the center button on the second device until the LED flashes blue and red.
2. Select the second device on your audio source.
3. LED turns blue on second device when successfully paired.

Pairing Bluetooth Device to a PC

If you are having difficulty pairing your BT1 earphones to your PC, you may need to update your drivers. Here are two ways to update your computer driver via the Intel® website.

1. **Manually:** This requires that you locate your wireless adapter and then download the specific driver update for that wireless adapter. Information and drivers are located here: [Manual Update](#).
2. **Intel Update Utility:** This requires you to download the update app, run the app and allow it to scan your computer for required driver updates. Download the app here: [Intel Update Utility](#).

Note: The Intel Update Utility is recommended because it requires fewer steps. Refer to your PC user manual for more information.

Bluetooth Accessory Quick Start Guides

- [BT1 quick start](#)
 - [BT2 quick start](#)
-

Charging the Earphones



Red LED indicates low battery.

1. Connect earphones to charging device using supplied cable.
2. LED is red while charging.
3. When earphones are charged, LED turns off.

Warning: Before charging, make sure the product is at room temperature, between 0 to 45°C (32 to 113°F).

Note: Use this product only with an agency approved power supply which meets local regulatory requirements (e.g., UL, CSA, VDE, CCC, INMETRO).

BT1 FAQ

For more information, or to view other Frequently Asked Questions, visit the [Shure FAQ](#).

Remote + Mic, Telephony, Voice Command and In-App use

Q.) How do I pair my wireless Sound Isolating™ earphones with my device?

A.) With the BT1 product OFF, activate pairing mode by holding center button for 7 seconds on the remote. Navigate to Bluetooth settings in the source device settings, and the device SHURE BT1 should appear in available devices. Select BT1, and your device should be paired.

Q.) How do I set up multi-point pairing? How do I change active devices?

A.) Multi-point pairing, a feature of Bluetooth 4, is set up automatically—pair a second device (power cycle by holding the power button down until the earphones turn off, and press again for 7 seconds to enter pairing mode). The playback between devices should be triggered by new activity (incoming call, new playback). If devices do not automatically recognize the BT1 as an output device, manually disconnect and re-select the BT1 in device settings.

Q.) Are my wireless Sound Isolating earphones designed for calls?

A.) The Bluetooth 4 protocol has both headset and stereo audio playback features built-in. The two-way audio and remote functions are included in that protocol, and the inline microphone located on the right side cable is provided for calls and voice commands.

Q.) Does the cable work with my iPhone/iPod/iPad/Android device?

A.) Any device supporting Bluetooth 4 stereo audio playback and telephony protocols is compatible, including Apple and many Android devices. We recommend downloading and installing the latest compatible operating system to ensure all drivers are up-to-date.

Q.) Do my wireless Sound Isolating earphones work with Siri® or Google®?

A.) Yes, hold the center button on the remote for 3 seconds to activate Siri, Google, or any other voice assistant service. (Source device dependent.)

Q.) How do I use voice commands?

A.) Hold down the multi-function center button (power/answer/end call) for 3 seconds to prompt voice command software. (Source device dependent)

Q.) What device controls do the cable and earphones support? How do I use them?

A.) The center button may be used for play, pause of media, and answering and ending of calls. Volume up (+) button can be depressed for 3 seconds to skip forward to the next song. The volume down (-) button can similarly be depressed for 3 seconds to skip to the beginning of the song (or to a previous song within approximately 5 seconds of the beginning of a track).

The center button will power down the earphones when held for 5 seconds. Holding down the power button for three seconds also powers the device back on.

Q.) Will my wireless Sound Isolating earphones work with fitness apps?

A.) Yes, most apps that have audio prompts will work, just like wired earphones.

Note: These earphones will not provide heart rate or other biometrics.

Battery, Durability, Range and Charging

Q.) Are my wireless Sound Isolating earphones IPX-rated for water resistance? Are they suited to exercise?

A.) The BT1 is not IPX-rated for water resistance. However, the SE112 and SE215 comprise two of the most durable earphones available on the market today. The cable, transmitter/receiver, and remote + mic pod are subject to the same stringent battery of tests for moisture resistance that all of our earphones undergo. Also, when used in conjunction with the clothing clip, the snug, comfortable fit of the Sound Isolating design and eartips, and wireform cable (SE215 and RMCE-BT1 only) provides long-wearing comfort, providing a secure seal with the ear canal during even the most intense workouts. As such, these (and any earphones paired with the RMCE-BT1) are completely suitable for exercise. However, we cannot recommend use during any activities where awareness of surroundings are necessary (such as cycling or driving), and where prohibited by law.

Q.) Why am I experiencing dropouts with my Bluetooth Sound Isolating earphones?

A.) While the Bluetooth 4 protocol defines standard range as up to 10 m (30 ft), the ideal distance between devices is significantly smaller, especially when outdoors where reflections are minimal. Similarly, the range can be much further in enclosed spaces, where a lot of reflections of the signal are permitted. Absorption of signal by skin or garments may impact connectivity (especially keeping the music device in a pocket with keys, credit cards, which may act as an unwanted antenna for the phone), and a line-of-sight signal should be established to troubleshoot any connectivity or dropout issues.

Q.) How long will the battery on my wireless Sound Isolating earphones last between charges?

A.) When new, the BT1 battery will play back music for up to 8 hours, depending on volume and type of music listened to.

Q.) How do I charge my earphones? How do I know when the battery is charged?

A.) The supplied USB cable can be plugged into any standard 5V USB connection, including those supplied with devices, and on computers or laptops. For safety, do not connect to charger producing higher than 1 A of current.

The LED light will be solid red when charging. When fully charged, the LED will turn off.

Q.) How long does it take to charge the battery?

A.) The battery charges fully in about 2 hours, depending on power source used. A “quick charge” will get up to two hours of playback on just fifteen minutes of charging time.

Q.) Can I listen while my earphones are charging?

A.) Yes. You can use the product while it is charging.

Use with SE Earphones

Q.) Why would I pick Bluetooth Sound Isolating earphones over wired Sound Isolating earphones?

A.) Wireless Sound Isolating earphones provide the great sound of wired SE earphones with the freedom of motion that separating your playback device from your earphones offers. This is ideal for high-impact exercise (running, spin classes) where movement of the body may cause entanglement and result in an uncomfortable pull on the ears. Wireless Sound Isolating earphones are also ideal for travel and commuting, where hands-free media control and telephony are key features.

Note:

Some airlines permit Bluetooth use in-flight. Check with your airline provider before travelling with the SE112-BT1, SE215-BT1 or RMCE-BT1.

The wireless Sound Isolating earphones may be ideal for iPhone 7 and other devices that do not have a standard headphone output as an alternative to the RMCE-LTG (for Lightning-equipped iOS devices, only).

The MMCX connectors standard on most SE earphones, like the SE215 and SE846, mean you don't have to choose between wired and wireless—simply add an RMCE Remote + Mic accessory cable, RMCE-LTG (for iPhone 7 and iPhone 7 Plus), or the EAC64 replacement detachable cable (if the telephony features of the Remote + Mic cable isn't required).

Q.) What models of SE earphones are the RMCE-BT1 for?

A.) All models of SE earphones with MMCX connectors, including SE215, SE315, SE425, SE535 and SE846 Sound Isolating earphones are compatible with the RMCE-BT1.

Q.) Do the BT1 cable and earphones support Bluetooth aptX codec?

A.) BT1 products do not support aptX codecs.

BT2 FAQ

For more information, or to view other Frequently Asked Questions, visit the [Shure FAQ](#).

Remote + Mic, Telephony, Voice Command and In-App use

Q.) How do I pair my wireless Sound Isolating earphones with my device?

A.) With the wireless earphones OFF, activate pairing mode by holding center button for 7 seconds on the remote. Navigate to Bluetooth settings in the source device settings, and the device SHURE BT2 should appear in available devices. Select SHURE BT2, and your device should be paired.

Q.) How do I set up multi-point pairing? How do I change active devices?

A.) Multi-point pairing is set up automatically—pair a second device (power cycle by holding the power button down until the earphones turn off, and press again for 7 seconds to enter pairing mode). The playback between devices should be triggered by new activity (incoming call, new playback). If devices do not automatically recognize the wireless earphones as an output device, manually disconnect and re-select in device settings.

Q.) Are my wireless Sound Isolating earphones designed for calls?

A.) The Bluetooth protocol has both headset and stereo audio playback features built-in. The two-way audio and remote functions are included in that protocol, and the inline microphone located on the right side cable is provided for calls and voice commands.

Q.) Does the cable work with my iPhone/iPod/iPad/Android device?

A.) Any device supporting Bluetooth stereo audio playback and telephony protocols is compatible, including Apple and many Android devices. We recommend downloading and installing the latest compatible operating system to ensure all drivers are up-to-date.

Q.) Do my wireless Sound Isolating earphones work with Siri?

A.) Yes. Hold the center button on the remote for 3 seconds to activate Siri or other voice service. (Source device dependent.)

Q.) How do I use voice commands?

A.) Hold down the multi-function center button (power/answer/end call) for 3 seconds to prompt voice command software. (Source device dependent)

Q.) What device controls do the cable and earphones support? How do I use them?

A.) The center button may be used for play, pause of media, and answering and ending phone calls. Volume up (+) button can also be depressed for 3 seconds to skip forward to the next song. The volume down (-) button can similarly be depressed for 3 seconds to skip to the beginning of the song (or to a previous song within approximately 5 seconds of the beginning of a track). The center button will power down the earphones when held for 5 seconds. Hold the power button down for three seconds to power the device back on.

Q.) Will my wireless Sound Isolating earphones work with fitness apps?

A.) Yes, most apps that have audio prompts will work, just like wired earphones.

Note: These earphones will not provide heart rate or other biometrics.

Battery, Durability, Range and Charging

Q.) Are my wireless Sound Isolating earphones IPX-rated for water resistance? Are they suited to exercise?

A.) These wireless earphones are not IPX-rated for water resistance. However, the cable, transmitter/receiver, and remote + mic pod are subject to the same stringent battery of tests for moisture resistance that all of our earphones undergo. Also, when used in conjunction with the clothing clip, the snug, comfortable fit of the Sound Isolating design and eartips, and wireform cable (SE215 and RMCE-BT2 only) provides long-wearing comfort, providing a secure seal with the ear canal during even the most intense workouts. As such, these (and any earphones paired with the RMCE-BT2) are completely suitable for exercise. However, we cannot recommend use during any activities where awareness of surroundings are necessary (such as cycling or driving), and where prohibited by law.

Q.) How long will the battery on my wireless Sound Isolating earphones last between charges?

A.) When new, the BT2 battery will play back music for up to 10 hours, depending on volume and audio listened to.

Q.) How do I charge my earphones? How do I know when the battery is charged?

A.) The supplied USB cable can be plugged into any standard 5V USB connection, including those supplied with devices, and on computers or laptops. For safety, do not connect to charger producing higher than 1 A of current.

The LED light will be solid red when charging. When fully charged, the LED will turn off.

Q.) How long does it take to charge the battery?

A.) The battery charges fully in about 2 hours, depending on power source used. A “quick charge” will get up to two hours of playback on just fifteen minutes of charging time.

Q.) Can I listen while my earphones are charging?

A.) Yes, you can use the product while it is charging.

Use with SE Earphones

Q.) Why would I pick wireless Sound Isolating earphones over wired earphones?

A.) Wireless Sound Isolating earphones provide the great sound of wired SE earphones with the freedom of motion that separating your playback device from your earphones offers. This is ideal for high-impact exercise (running, spin classes) where movement of the body may cause entanglement and result in an uncomfortable pull on the ears. Wireless earphones are also ideal for travel and commuting, where hands-free media control and telephony are key features.

Note: Some airlines permit Bluetooth use in-flight. Check with your airline provider before travelling with the SE112-BT1, SE215-BT1 or RMCE-BT1 or RMCE-BT2.)

The wireless earphones may be ideal for iPhone 7 and other devices that do not have a standard headphone output as an alternative to the RMCE-LTG (for Lighting-equipped iOS devices only).

The MMCX connectors standard on most SE earphones, like the SE215 and SE846, mean you don't have to choose between wired and wireless. Simply add an RMCE Remote + Mic accessory cable, RMCE-LTG (for iPhone 7 and iPhone 7 Plus), or the EAC64 replacement detachable cable (if the telephony features of the Remote + Mic cable isn't required).

Q.) What models of SE earphones are the RMCE-BT2 for?

A.) All models of SE earphones with MMCX connectors, including SE215, SE315, SE425, SE535 and SE846 Sound Isolating earphones are compatible with the RMCE-BT2.

Q.) Do the BT2 cable and earphones support Bluetooth aptX™ codec?

A.) Yes. BT2 products support Qualcomm® aptX audio, aptX HD, aptX Low Latency, AAC, SBC aptX codecs.

Why am I experiencing dropouts with my wireless Sound Isolating earphones?

While the Bluetooth protocol defines standard range as up to 10 m (30 ft), the ideal distance between devices is significantly smaller, especially when outdoors where reflections are minimal. Similarly, the range can be much further in enclosed spaces, where a lot of reflections of the signal are permitted. Absorption of signal by skin or garments may impact connectivity (especially keeping the music device in a pocket with keys, credit cards, which may act as an unwanted antenna for the phone), and a line-of-sight signal should be established to troubleshoot any connectivity or dropout issues.

How can I get the most reliable wireless performance with BT2?

Your Shure RMCE-BT2 supports multiple Bluetooth codecs: SBC, AAC, Qualcomm aptX audio, aptX HD, aptX Low Latency codecs. Bluetooth codecs/transmissions have varying wireless performance based on:

- Interference from other wireless devices
- Distance from source
- Physical barriers between source and receiver, such as walls or people
- The density/size of the wireless transmission. (codec related)

iOS devices automatically set the codec, and an end user cannot make any changes, or choose a different codec. (iOS supports SBC and AAC only).

Android devices with the latest firmware updates can select which codec is used in the Bluetooth settings menu of your Android source.

Note: Android users: To maximize performance, and minimize signal dropouts, choose the codec that works best in your environment.

Accessories

- Earphone Sleeves
- Replacement Cables
- Carrying Cases
- Music Phone Accessory Cables
- Volume Control
- Adapters

For information about earphone accessories and other Shure products visit:

<http://www.shure.com/en-US/products/accessories>

Accessory Cables for Mobile Devices Quick Start Guides

RMCE cables are compatible with all Shure earphones.

- [Remote and Mic Lightning Cable for iOS \(RMCE-LTG\)](#)
- [Remote and Mic Universal Cable for iOS and Android \(RMCE-UNI\)](#)
- [Remote and Mic USB Cable for Android \(RMCE-USB\)](#)

In North America:

Custom Earphone Sleeves

Those who use earphones regularly for extended periods of time often find custom-fit molded sleeves offer the best comfort and sound isolation. Through a partnership between Shure Incorporated and Sensaphonics Hearing Conservation, custom sleeves are available for use with your Shure Sound Isolating™ Earphones.

Please contact Sensaphonics for more information.

Inserts d'écouteur sur mesure

Les personnes qui utilisent des écouteurs régulièrement pendant de longues périodes trouvent souvent que des inserts moulés sur mesure offrent le meilleur confort et la meilleure isolation acoustique. Grâce à un partenariat entre Shure Incorporated et Sensaphonics Hearing Conservation, des inserts sur mesure sont disponibles pour les écouteurs Sound Isolating de Shure.

Prière de consulter Sensaphonics pour plus de détails.

Manguitos personalizados para auriculares

Quienes usan auriculares con regularidad por lapsos prolongados a menudo hallan que los manguitos moldeados a medida ofrecen la mejor comodidad y aislamiento del ruido. Por medio de una asociación de Shure Incorporated con Sensaphonics Hearing Conservation, se ofrecen manguitos personalizados para uso con los auriculares aislantes del ruido Sound Isolating de Shure.

Comuníquese con Sensaphonics para más información.



Sensaphonics Hearing Conservation
 660 N. Milwaukee Avenue
 Chicago, IL 60622
 Phone: In Chicago: (312) 432-1714
 Toll Free: (877) 848-1714
 E-mail: saveyourears@sensaphonics.com
<http://www.sensaphonics.com>

Specifications

Transducer Type

SE535/535LTD Red	Triple balanced-armature drivers
SE425	Dual balanced-armature drivers
SE315	Single High-Definition MicroDriver
SE215	Single Dynamic MicroDriver

Sensitivity

at 1 kHz

SE535/535LTD Red	119 dB SPL/mW
SE425	109 dB SPL/mW
SE315	116 dB SPL/mW
SE215	107 dB SPL/mW
SE112	105 dB SPL/mW

Impedance

at 1 kHz

SE535/535LTD Red	36 Ω
SE425	22 Ω
SE315	27 Ω

SE215	17 Ω
SE112	16 Ω

Frequency Range

SE535	18 Hz–19 kHz
SE535LTD Red	18 Hz–19.5 kHz
SE425	20 Hz–19 kHz
SE315	22 Hz–18.5 kHz
SE215	22 Hz–17.5 kHz
SE112	25 Hz–17 kHz

Input Connector

Gold-plated 3.5 mm (1/8") stereo mini jack plug with 6.35 mm (1/4") threaded adapter

Net Weight

SE535	30 g (1 oz.)
SE425	30 g (1 oz.)
SE315	30 g (1 oz.)

Operating Temperature

SE535	-18°C to 57°C (0°F to 135°F)
SE425	-18°C to 57°C (0°F to 135°F)
SE315	-18°C to 57°C (0°F to 135°F)

Storage Temperature

SE535	-29°C to 74°C (-20°F to 165°F)
SE425	-29°C to 74°C (-20°F to 165°F)
SE315	-29°C to 74°C (-20°F to 165°F)

Bluetooth Specifications

Integrated Microphone

RMCE-BT1	MEMS
RMCE-BT2	MEMS

Polar Pattern

RMCE-BT1	Omnidirectional
RMCE-BT2	Omnidirectional

Sensitivity

RMCE-BT1	-11 dBV at 1 kHz (Pa=94 dB SPL)
RMCE-BT2	-38 dBV at 1 kHz (Pa=94 dB SPL)

Compatible Earphones

RMCE-BT1	All Shure detachable earphones with MMCX connectivity
RMCE-BT2	All Shure detachable earphones with MMCX connectivity

Compatible Sources

RMCE-BT1	Any A2DP Bluetooth stereo source
RMCE-BT2	Any A2DP Bluetooth stereo source

Antenna Type

RMCE-BT1	Chip
RMCE-BT2	Chip

Antenna Gain

RMCE-BT1	+2.13 dBi
RMCE-BT2	+1.6 dBi

Bluetooth Version

RMCE-BT1	4.1
RMCE-BT2	5

Operating Frequency

RMCE-BT1	2402 to 2480 MHz
RMCE-BT2	2402 to 2480 MHz

Modulation Type

RMCE-BT1	FHSS
RMCE-BT2	FHSS

RF Output Power

RMCE-BT1	+5.38 dBm (E.I.R.P)
RMCE-BT2	+7.45 dBm (E.I.R.P)

Supported Codecs

RMCE-BT1	SBC
RMCE-BT2	aptX™, aptX HD, aptX Low Latency, SBC, AAC

Range

RMCE-BT1	10 m (32.8 ft)
RMCE-BT2	10 m (32.8 ft)

Dimensions

Cable Length

SE112-BT1	760.0 mm (29.9 in.)
RMCE-BT1	790.0 mm (31.1 in.)
RMCE-BT2	736.6 mm (29.0 in.)

Net Weight

SE112-BT1	17.5 g (0.62 oz.)
RMCE-BT1	13.8 g (0.47 oz.)
RMCE-BT2	18.0 g (0.63 oz.)

Operating Temperature

SE215-BT1	0°C to 45°C (32°F to 113°F)
SE112-BT1	0°C to 45°C (32°F to 113°F)
RMCE-BT2	0°C to 45°C (32°F to 113°F)

Storage Temperature

SE215-BT1	-10°C to 50°C (14°F to 122°F)
SE112-BT1	-10°C to 50°C (14°F to 122°F)
RMCE-BT2	-10°C to 50°C (14°F to 122°F)

Battery Specifications

Battery Type

RMCE-BT1	Rechargeable Li-Ion
RMCE-BT2	Rechargeable Li-Ion

Nominal Voltage

RMCE-BT1	3.7 V DC
RMCE-BT2	3.7 V DC

Battery Life

RMCE-BT1	up to 8 hours
RMCE-BT2	up to 10 hours

Total Battery Life

RMCE-BT1	120 mAh
-----------------	---------

RMCE-BT2	200 mAh
-----------------	---------

Charging Requirements

USB Source

RMCE-BT1	5 V DC, 100 mA, minimum
RMCE-BT2	5 V DC, 100 mA, minimum

Charging Time

RMCE-BT1	2 hours
RMCE-BT2	2 hours

Quick Charge

RMCE-BT1	Up to 1.5 hours of play time with 15 minutes of charge time
RMCE-BT2	Up to 1.5 hours of play time with 15 minutes of charge time

Battery Charging Temperature Range

RMCE-BT1	0 to 45 °C (32 to 113 °F)
RMCE-BT2	0 to 45 °C (32 to 113 °F)

Headphone Amplifier Specifications

Output Noise

RMCE-BT1	8.5 uVrms
RMCE-BT2	2.2 uVrms

THD+N

Typical

RMCE-BT1	0.1%
RMCE-BT2	0.02%

Frequency Response

RMCE-BT1	10 to 22,000 Hz, +- 0.5 dB
RMCE-BT2	10 to 22,000 Hz, +- 0.5 dB

Output Impedance

RMCE-BT1	3.9 Ω
RMCE-BT2	0.6 Ω

SAFETY PRECAUTIONS



Before using this product, please read and save the enclosed warnings and safety instructions.

WARNING FOR ALL EARPHONES!

Use, clean, and maintain earphones according to manufacturer's instructions.

SAFETY PRECAUTIONS

The possible results of incorrect use are marked by one of the two symbols—"WARNING" and "CAUTION"—depending on the imminence of the danger and the severity of the damage.

	WARNING: Ignoring these warnings may cause severe injury or death as a result of incorrect operation.
	CAUTION: Ignoring these cautions may cause moderate injury or property damage as a result of incorrect operation.

WARNING

- If water or other foreign objects enter the inside of the device, fire or electric shock may result.
- Do not attempt to modify this product. Doing so could result in personal injury and/or product failure.
- Do not use when a failure to hear your surroundings could be dangerous, such as while driving, or when biking, walking, or jogging where traffic is present and accidents could occur.
- Keep this product and its accessories out of reach of children. Handling or use by children may pose a risk of death or serious injury. Contains small parts and cords that may pose risk of choking or strangulation.
- Prior to inserting the earphone, always recheck the sleeve to make sure it is firmly attached to the nozzle to decrease the risk of sleeves detaching from the nozzle and becoming lodged in your ear. If a sleeve becomes lodged in your ear, seek professional medical assistance to remove the sleeve.
- Stop using the earphones and consult a medical professional if you experience irritation, excessive wax buildup, or other discomfort.

CAUTION

- Never disassemble or modify the device, as failures may result.
- Do not subject to extreme force and do not pull on the cable or failures may result.
- Keep the earphone dry and avoid exposure to extreme temperatures and humidity.
- If you are currently receiving ear treatment, consult your physician before using this device.



High sound pressure

Hearing damage risk

To prevent possible hearing damage, do not listen at high volume levels for long periods.

IMPORTANT SAFETY INSTRUCTIONS

1. READ these instructions.

2. KEEP these instructions.
3. HEED all warnings.
4. FOLLOW all instructions.
5. DO NOT use this apparatus near water.
6. CLEAN ONLY with dry cloth.
7. DO NOT block any ventilation openings. Install in accordance with the manufacturer's instructions.
8. DO NOT install near any heat sources such as radiators, heat registers, stoves, or other apparatus (including amplifiers) that produce heat.
9. DO NOT defeat the safety purpose of the polarized or grounding type plug. A polarized plug has two blades with one wider than the other. A grounding type plug has two blades and a third grounding prong. The wider blade or the third prong are provided for your safety. If the provided plug does not fit into your outlet, consult an electrician for replacement of the obsolete outlet.
10. PROTECT the power cord from being walked on or pinched, particularly at plugs, convenience receptacles, and the point where they exit from the apparatus.
11. ONLY USE attachments/accessories specified by the manufacturer.
12. USE only with a cart, stand, tripod, bracket, or table specified by the manufacturer, or sold with the apparatus. When a cart is used, use caution when moving the cart/apparatus combination to avoid injury from tip-over.



13. UNPLUG this apparatus during lightning storms or when unused for long periods of time.

For Products That Use Bluetooth

WARNING

- Follow instructions from manufacturer.
- Product battery may explode or release toxic materials. Risk of fire or burns. Do not open, crush, modify, disassemble, heat above 140°F (60°C), or incinerate.
- Attention should be drawn to the environmental aspects of battery disposal.
- Product shall not be exposed to excessive heat such as sunshine, fire, or the like.
- Do NOT make unauthorized alterations to this product.

CAUTION

- Follow applicable laws regarding mobile phone and headphone use while driving.
- This product contains magnetic material. Consult your physician on whether this might affect your implantable medical device.
- Batteries (battery pack or batteries installed) shall not be exposed to excessive heat such as sunshine, fire or the like
- Batteries (battery pack or batteries installed) shall not be crushed or cut
- Batteries (battery pack or batteries installed) shall not be subjected to extremely low air pressure
- Risk of fire or explosion if the battery is replaced by an incorrect type

Information to the user

This device complies with part 15 of the FCC Rules. Operation is subject to the following two conditions:

1. This device may not cause harmful interference.

2. This device must accept any interference received, including interference that may cause undesired operation.

Note: This equipment has been tested and found to comply with the limits for a Class B digital device, pursuant to part 15 of the FCC Rules. These limits are designed to provide reasonable protection against harmful interference in a residential installation. This equipment generates uses and can radiate radio frequency energy and, if not installed and used in accordance with the instructions, may cause harmful interference to radio communications. However, there is no guarantee that interference will not occur in a particular installation. If this equipment does cause harmful interference to radio or television reception, which can be determined by turning the equipment off and on, the user is encouraged to try to correct the interference by one or more of the following measures:

- Reorient or relocate the receiving antenna.
- Increase the separation between the equipment and the receiver.
- Connect the equipment to an outlet on a circuit different from that to which the receiver is connected.
- Consult the dealer or an experienced radio/TV technician for help.

This device contains licence-exempt transmitter(s)/receiver(s) that comply with Innovation, Science and Economic Development Canada's licence-exempt RSS(s). Operation is subject to the following two conditions:

1. This device may not cause interference.
2. This device must accept any interference, including interference that may cause undesired operation of the device.

L'émetteur/récepteur exempt de licence contenu dans le présent appareil est conforme aux CNR d'Innovation, Sciences et Développement économique Canada applicables aux appareils radio exempts de licence. L'exploitation est autorisée aux deux conditions suivantes :

1. L'appareil ne doit pas produire de brouillage;
2. L'appareil doit accepter tout brouillage radioélectrique subi, même si le brouillage est susceptible d'en compromettre le fonctionnement.

Changes or modifications not expressly approved by the party responsible for compliance could void the user's authority to operate the equipment.

Note: Testing is based on the use of supplied and recommended cable types. The use of other than shielded (screened) cable types may degrade EMC performance.

Environmentally friendly disposal



Old electrical appliances must not be disposed of together with the residual waste, but have to be disposed of separately. The disposal at the communal collecting point via private persons is for free. The owner of old appliances is responsible to bring the appliances to these collecting points or to similar collection points. With this little personal effort, you contribute to recycle valuable raw materials and the treatment of toxic substances.

Certifications

Visit www.shure.com for the latest regulatory and compliance information.

Note: Testing is based on the use of supplied and recommended cable types. The use of other than shielded (screened) cable types may degrade EMC performance.

This product meets the Essential Requirements of all relevant European directives and is eligible for CE marking.

This equipment complies with IC RSS-102 radiation exposure limits set forth for an uncontrolled environment. This transmitter must not be co-located or operating in conjunction with any other antenna or transmitter.

Cet équipement est conforme aux limites d'exposition aux radiations IC CNR-102 établies pour un environnement non contrôlé. Cet émetteur ne doit pas être situé au même endroit ou fonctionner avec une autre antenne ou un autre émetteur.

This Class B digital apparatus complies with Canadian ICES-003. Cet appareil numérique de la classe B est conforme à la norme NMB-003 du Canada.

CE Notice: Hereby, Shure Incorporated declares that this product with CE Marking has been determined to be in compliance with European Union requirements. The full text of the EU declaration of conformity is available at the following site: <https://www.shure.com/en-EU/support/declarations-of-conformity>.

Authorized European representative:

Shure Europe GmbH

Department: Global Compliance

Jakob-Dieffenbacher-Str. 12

75031 Eppingen, Germany

Phone: +49-7262-92 49 0

Fax: +49-7262-92 49 11 4

Email: EMEAsupport@shure.de



The Bluetooth word mark and logos are registered trademarks owned by the Bluetooth SIG, Inc. and any use of such marks by Shure Incorporated is under license. Other trademarks and trade names are those of their respective owners.



Qualcomm aptX is a product of Qualcomm Technologies, Inc. and/or its subsidiaries.

Qualcomm is a trademark of Qualcomm Incorporated, registered in the United States and other countries. aptX is a trademark of Qualcomm Technologies International, Ltd., registered in the United States and other countries.

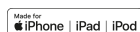

Use of the Made for Apple badge means that an accessory has been designed to connect specifically to the Apple product(s) identified in the badge and has been certified by the developer to meet Apple performance standards. Apple is not responsible for the operation of this device or its compliance with safety and regulatory standards.

Apple, iPad, iPhone, iPod and Lightning are trademarks of Apple Inc., registered in the U.S. and other countries. tvOS is a trademark of Apple Inc. The trademark "iPhone" is used in Japan with a license from Aiphone K.K.

Mac® and Lightning® are registered trademarks of Apple Inc.

LIMITED WARRANTY

Shure Incorporated ("Shure") hereby warrants to the original consumer purchaser only that, except as otherwise specified below, this product will be free in normal use of any defects in materials and workmanship for a period of two (2) years from the consumer's original date of purchase directly from Shure or from a Shure-authorized reseller.

Any rechargeable batteries contained in or packaged with this product are so warranted for a period of one (1) year from the consumer's original date of purchase. However, rechargeable batteries are consumable and their capacity will be reduced over

time based on temperature, amount of time in storage, charging cycles, and other factors; hence reduction in battery capacity does not constitute a defect in material or workmanship.

At its sole option, Shure will repair or replace the defective product and promptly return it to you. In order for this warranty to be valid, the consumer must, at the time the product is returned, provide proof of purchase in the form of the original purchase receipt directly from Shure or from a Shure-authorized reseller. If Shure elects to replace the defective product, then Shure reserves the right to replace the defective product with another product of the same model or a model of at least comparable quality and features in Shure's sole determination.

If you believe this product is defective within the warranty period, carefully repack the unit, insure it and return it with proof of purchase, postage prepaid, to Shure Incorporated, Attention: Service Department, at the address below.

Outside of the United States, return the product to your dealer or Authorized Service Center. Addresses are listed on www.Shure.com or can be obtained by contacting Shure at the address listed below.

This warranty is not transferable. This warranty does not apply in cases of abuse or misuse of the product, use contrary to Shure's instruction, ordinary wear and tear, an act of God, negligent use, purchase from a party other than Shure or a Shure-authorized reseller, unauthorized repair, or modification of the product.

ALL IMPLIED WARRANTIES OF MERCHANTABILITY OR FITNESS FOR A PARTICULAR PURPOSE ARE HEREBY DISCLAIMED TO THE EXTENT PERMITTED UNDER APPLICABLE LAWS AND, TO THE EXTENT NOT PERMITTED, ARE HEREBY LIMITED TO THE DURATION AND TERMS OF THIS WARRANTY. SHURE ALSO HEREBY DISCLAIMS ALL LIABILITY FOR INCIDENTAL, SPECIAL, OR CONSEQUENTIAL DAMAGES.

Some states do not allow limitations on how long an implied warranty lasts, or the exclusion or limitation of incidental or consequential damages, so the above limitation may not apply to you. This warranty gives you specific legal rights, and you may have other rights which vary from state to state.

This warranty does not restrict the rights of the consumer mandated under applicable laws.

THIS WARRANTY SUPERSEDES ALL OTHER WARRANTIES THAT ARE ASSOCIATED OR INCLUDED WITH THIS PRODUCT, EXCEPT THAT ANY SOFTWARE CONTAINED IN OR PACKAGED WITH THIS PRODUCT IS EXCLUDED FROM THIS WARRANTY AND INSTEAD SHALL BE COVERED BY THE WARRANTY, IF ANY, PROVIDED IN SHURE'S END USER LICENSE AGREEMENT ACCOMPANYING SUCH SOFTWARE.

FOR ORIGINAL PURCHASES IN AUSTRALIA ONLY

LIMITED WARRANTY AGAINST DEFECTS

Shure Incorporated ("Shure") hereby warrants to the original consumer purchaser in Australia only that, except as otherwise specified below, this product will be free in normal use of any defects in materials and workmanship for a period of two (2) years from the consumer's original date of purchase directly from Shure or from a Shure-authorized reseller.

Any rechargeable batteries contained in or packaged with this product are so warranted for a period of one (1) year from the consumer's original date of purchase. However, rechargeable batteries are consumable and their capacity will be reduced over time based on temperature, amount of time in storage, charging cycles, and other factors; hence reduction in battery capacity does not constitute a defect in material or workmanship.

At its sole option, Shure will repair or replace the defective product and promptly return it to you. In order for this warranty to be valid, the consumer must, at the time the product is returned, provide proof of purchase in the form of the original purchase receipt directly from Shure or from a Shure-authorized reseller. If Shure elects to replace the defective product, then Shure reserves the right to replace the defective product with another product of the same model or a model of at least comparable quality and features in Shure's sole determination.

If you believe this product is defective within the warranty period, carefully repack the unit, insure it and return it with proof of purchase, postage prepaid, to Shure Incorporated, Attention: Service Department, at the address below.

Outside of the United States, return the product to your dealer or Authorized Service Center. Addresses are listed on www.Shure.com or can be obtained by contacting Shure at the address listed below.

This warranty is not transferable. This warranty does not apply in cases of abuse or misuse of the product, use contrary to Shure's instruction, ordinary wear and tear, an act of God, negligent use, purchase from a party other than Shure or a Shure-authorized reseller, unauthorized repair, or modification of the product.

ALL IMPLIED WARRANTIES OF MERCHANTABILITY OR FITNESS FOR A PARTICULAR PURPOSE ARE HEREBY DISCLAIMED TO THE EXTENT PERMITTED UNDER APPLICABLE LAWS AND, TO THE EXTENT NOT PERMITTED, ARE HEREBY LIMITED TO THE EXTENT PERMITTED TO THE DURATION AND TERMS OF THIS WARRANTY. SHURE ALSO HEREBY DISCLAIMS ALL LIABILITY FOR INCIDENTAL, SPECIAL, OR CONSEQUENTIAL DAMAGES FOR ANY PURCHASER ACQUIRING THIS PRODUCT, EXCEPT THAT THIS DOES NOT CONSTITUTE A DISCLAIMER OF RIGHTS GUARANTEED TO ANY "CONSUMER" UNDER THE AUSTRALIAN CONSUMER LAW.

This warranty gives purchasers of this product in Australia specific legal rights which are in addition to the rights and remedies of consumers under the Australian Consumer Law, which cannot be excluded or limited. If you are a "consumer" under the Australian Consumer Law, you are entitled to a replacement or refund for a major failure and for compensation for any other reasonably foreseeable loss or damage. You are also entitled to have the goods repaired or replaced if the goods fail to be of acceptable quality and the failure does not amount to a major failure.

THIS WARRANTY SUPERSEDES ALL OTHER WARRANTIES THAT ARE ASSOCIATED OR INCLUDED WITH THIS PRODUCT, EXCEPT THAT ANY SOFTWARE CONTAINED IN OR PACKAGED WITH THIS PRODUCT IS EXCLUDED FROM THIS WARRANTY AND INSTEAD SHALL BE COVERED BY THE WARRANTY, IF ANY, PROVIDED IN SHURE'S END USER LICENSE AGREEMENT ACCOMPANYING SUCH SOFTWARE.

Service and Repair Information

Service and repair for Shure products is handled by Shure Incorporated and our Authorized Distribution Centers. Click "Get Started" to follow a sequence of steps that will help you to determine whether your product needs to be sent off for service or repair and direct you to the necessary actions.

Note: To receive service or repairs for your Shure product, you will be required to mail us your product.

[Start the Service and Repair Process](#)

Service Centers

United States, Canada, Latin America, Caribbean

Shure Incorporated
Attn: Service Department
945 Chaddick Dr.
Wheeling, IL 60090-6449 U.S.A.

Europe, Middle East, and Africa

Shure Europe GmbH
Attn: Service
Jakob-Dieffenbacher-Str. 12,
75031 Eppingen, Germany

Indonesia Service Center Resmi:

Jakarta Hotline (021) 612 6388
Medan (061) 6612550
Surabaya (031) 5032219
Jogjakarta (0274) 371710
Denpasar (0361) 766788
Makasar (0411) 324652